

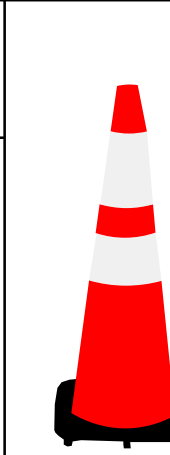

?:
 ?:
 ?:
 ?:

Safety Reminders / Adverse Conditions



Work Zone General Comments:

REMEMBER: Work zone area conditions may have changed for this job! Everyone is responsible for verifying the above safety information is correct prior to any work being performed each day.

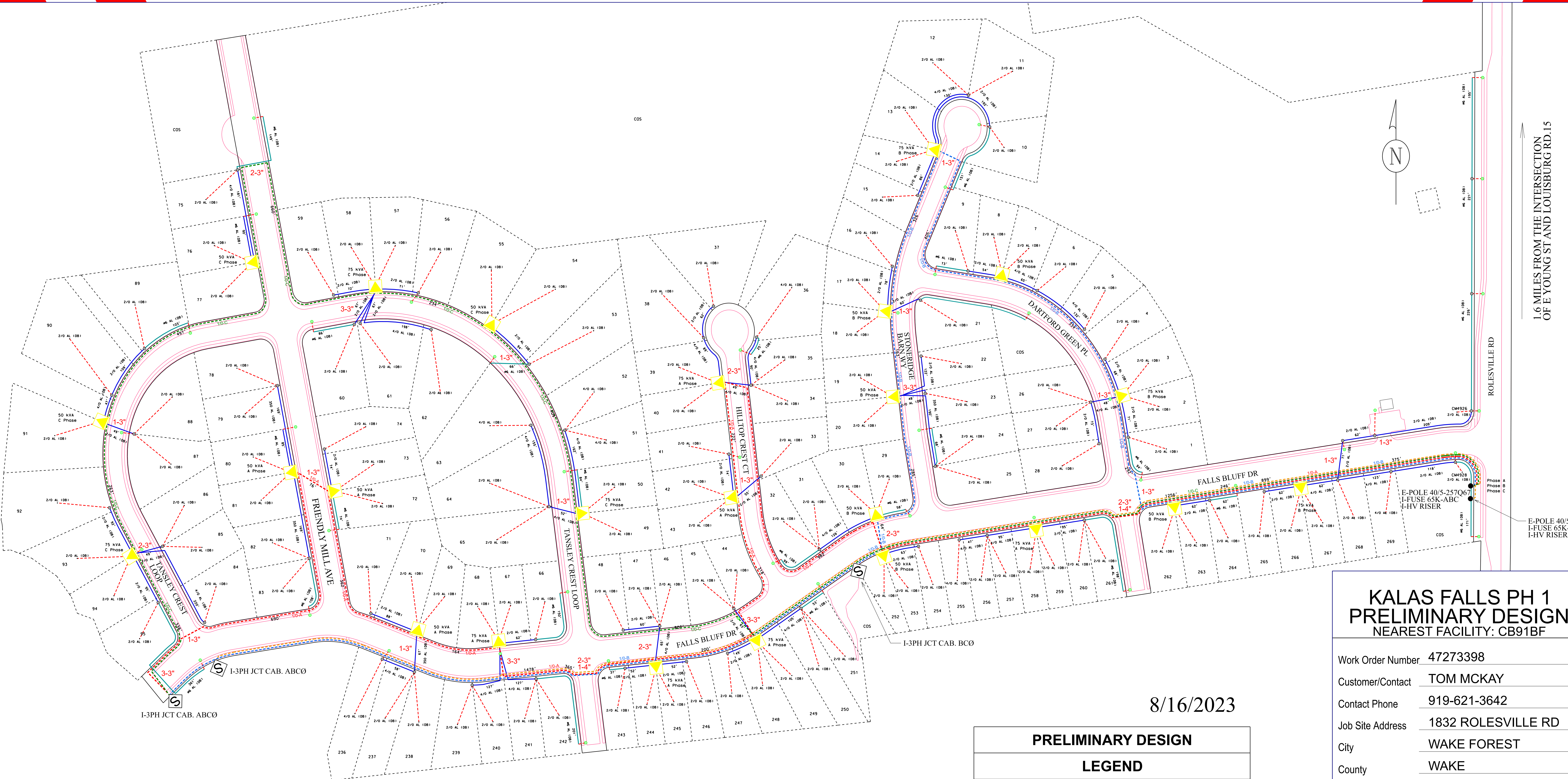

I-3PH JCT CAB. ABCØ

I-3PH JCT CAB. BCØ

**KALAS FALLS PH 1
 PRELIMINARY DESIGN**
 NEAREST FACILITY: CB91BF

Work Order Number	47273398
Customer/Contact	TOM MCKAY
Contact Phone	919-621-3642
Job Site Address	1832 ROLESVILLE RD
City	WAKE FOREST
County	WAKE
State, Zip	NC, 27587
Designer	JACKSON BLIZZARD
Designer Phone	336-756-3209
CSD Designer	LAMARCUS JENKINS
Circuit ID	T5205B12
Primary Voltage	22.86 / 13.2 kV
Permit Required	Yes ___ No ___
Permit Type/No.	_____
Permit Type/No. 2	_____
Permit Type/No. 3	_____
Revision Date	_____

8/16/2023

PRELIMINARY DESIGN

LEGEND

- UG PRIMARY CABLE
- UG SECONDARY / STREET LIGHT CABLE
- UG SERVICE CABLE
- ⊙ PERMANENT / TEMPORARY PEDESTAL STREET LIGHT
- POLE / PRIMARY TERMINATION POINT
- ▲ SINGLE PHASE PAD-MOUNTED TRANSFORMER
- Ⓢ JUNCTION ENCLOSURE / PRIMARY MODULE

DEVELOPER: _____

APPROVER: _____

DATE: _____

PHASE	TOTAL KVA	FUSE SIZE	OPEN POINT
B	525	65K	N/A
A	575	65K	N/A
C	375	65K	N/A
750	N/A	65K	N/A